



BUILT FOR WORK

DESIGN • BUILD • LEASE • HIRE • SALES

QUOTE NUMBER: #0000
CLIENT: PROPOSAL
PRODUCT/PROJECT: DAF XF 530 / Cheesewedge / Palfinger PK62002





ABOUT US

MV Commercial is one of the leading specialist commercial vehicle companies in the UK.

For the last two decades we have been supplying light and heavy commercials to some of the top companies across the UK. Operating from three main depots in Airdrie, Haydock and London Luton, our fleet of more than 1500 specialist vehicles, backed by over 130 staff, allows us to supply any size fleet to businesses of all sizes, from owner-drivers to multi-nationals.

We believe we provide an altogether better experience by investing heavily in our vehicles, facilities, technology and staff training, as well as going the extra mile to understand your industry and your exact needs so we can provide you with the right truck at the right price.

Because we are independent of any single manufacturer, we believe we offer greater choice, quicker turnarounds and unbiased advice on hiring the most appropriate commercial vehicle for your business.

Our flexible approach to contract hire and lease offers an affordable way to manage and grow your commercial fleet. We have a friendly, knowledgeable staff who maintain each and every one of our vehicles to the highest standards, and we are proud that they are some of the best and most reliable on the UK roads.

For all your commercial vehicle needs, whether it is short-term hire to cover a busy period or long-term contract leasing, refreshing your fleet to building specialist vehicles, make MV Commercial your first call.

A handwritten signature in black ink that reads 'Thomas O'Rourke'.

Tom O'Rourke

THE MV COMMERCIAL ADVANTAGE

- Nationwide Network of Service Partners
- Depots Across the UK
- Stock Built Ready to Go
- Independent of Any One Manufacturer
- On-site Fabrication Facility
- Integrated Shotblasting and Paint Facilities
- Paint Ovens and Blast Bays in a 15000ft² Facility
- Expert Hydraulic Engineers
- In-house Design Engineers
- End-to-End Build Management
- Specialised Vehicle Build Experts

Vehicle Summary XF 530 FAX 8X2 Rigid POV for 6.4m W/Base (530)

Cab version	Space Cab
Side collars	No side collars
Cab colour.....	H3279WHITE
Driver seat.....	Driver seat: Luxury Air
Upper bunk execution	No upper bunk / no luggage carrier
Safety regulations.....	No safety regulations
Front axle.....	Front: 2x 9.00 t, parabolic, 183N
Rear axle.....	Rear: 11.50 + 7.50 t, air suspension, SR1347
Supplier tyres	Goodyear
Tyres fr1 or fr axles.....	F1,385/55R22.5GO KMAXS2 160/000 K Steering BBA
Tyres fr2 or leading axle.....	F2,385/55R22.5GO KMAXS2 160/000 K Steering BBA
Tyres driven rear axle(s)	R1,315/70R22.5GO KMAXD2 154/150 L Traction CBA
Tyres driven re2 or trailing axle	R2,315/70R22.5GO KMAXS2 156/150 L Steering CBB
Spare tyre	SP, not applicable
Engine.....	Engine MX-13, 390 kW/530 hp. Cab Badge: 530
Exhaust emission.....	Exhaust emission Euro 6
Gearbox execution.....	Automated gearbox, TraXon, 12 speeds
Gearbox	12-speed TraXon 12TX2620 DD, 16.69-1.00
Rear axle ratio.....	Rear axle ratio 2.40
Retarder system	MX Engine Brake
Wheelbase / rear overhang.....	Wheelbase 5.70 m / rear overhang 2.00 m
Chassis component layout.....	Standard component location
Exhaust discharge position.....	Exhaust pipe horizontal, low
EAS position.....	EAS unit behind second front axle RH
Fuel tank position	Fuel tank right
Tank for AdBlue® position and content	Tank for AdBlue® 45 l, left-hand side chassis
Chassis weight related gross vehicle mass	Chassis weight related technical GVM max 37000 kg
GVM.....	
Drawbar related max GCM	Drawbar related max GCM 56000 kg
Vehicle warranty	Standard Warranty - 1Y Full - 2nd year DL - 1Y BD

Detailed Specification XF 530 FAX 8X2 Rigid POV for 6.4m W/Base (530)

Cab exterior	<ul style="list-style-type: none"> - Space Cab with galvanised steel bumper, tinted glass and electric window openers. Main mirrors and wide angle mirrors electrically heated. Cab width 2490 mm. - Maintenance free 4-point mechanical cab suspension with integrated shock absorbers. - Translucent external sun visor above the windscreen, colour green. - Bi-reflector halogen head lights with impact-resistant Lexan lens. - Head light beam for left-hand traffic. - Daytime running lights with four LED's at each side, integrated in the head light units. - Bumper mounted fog lights. - Two hazard beacon lights on the cab roof. - Front view mirror to comply with EC directive 2003/97/EC for frontal field of view. - Central door lock system with exterior light check function. Includes 2 remote control units with integrated snake blade key with flip mechanism and 1 additional key with transponder only.
Colours	<ul style="list-style-type: none"> - Cab colour: H3279WHITE - Colour of headlamp panel and bumper: Brilliant White. - Lower step Brilliant White, cab steps and wing Stone Grey. - Air intake, door handles and mirror covers black for cab colour Brilliant White. - Chassis colour grey.
Cab interior	<ul style="list-style-type: none"> - Right-hand drive. - Black steering wheel with soft grip finish. - Cab interior trim colour Dark Sand. - Cab interior decoration Delta black. - Soft woven, fabric door covering. - Air suspended driver seat - Luxury Air. High backed with adjustable shoulder support. Two-step seat heating. Upholstery Marilyn for the seat facing, Uni NF for the borders and Tony for the edges. Air gun connection at the rear of the seat console. - Arm rest on the driver seat. - High backed basic, fixed co-driver seat. Upholstery Marilyn for the seat facing, Uni NF for the borders and Tony for the edges. - Adjustable arm rest at the inner side of the co-driver seat. - Seat belts black. - Refrigerator drawer 42 litres with luxury aluminium look grip underneath the lower bunk. - Preparation for air blow gun. - Storage below the lower bunk: left-hand side - airtight box 150 litres with external hatch and open box 60 litres; right-hand side - open box 150 litres with external hatch and open box 85 litres; centre part - open box 25 litres with bottle holder at the front and open box 65 litres with moveable partition next to the refrigerator. Spacers are used below the mattress for extra ventilation, in order to remove damp from the refrigerator - Lower bunk with standard, foam mattress. - Curtains along the windscreen and the side windows.

Detailed Specification XF 530 FAX 8X2 Rigid POV for 6.4m W/Base (530)

	<ul style="list-style-type: none"> - Cab climate control automatically controls cab temperature, blower, air distribution and air conditioning - Water-to-air 3.8 kW auxiliary cab heater with residual heat pump. Control panel with 7-day timer. - Pollen filter with activated carbon to eliminate traffic and engine blow-by gasses and odours. Effectiveness 85% for particles up to 0.5 micron and 98% for particles up to 10 micron. - Glass roof hatch with electric control. - Electric window openers. - Accessory power supply to the roof console 12V/20A, 2x 24V/15A and 2x 24V/40A. - ECAS remote control to activate normal driving height, to raise/lower the rear axle and to stop any adjustment.
<p>Communication and driving management</p>	<ul style="list-style-type: none"> - Universal FMS connector. - DAF Connect is an online fleet management system giving insight in relevant truck, driver and location information. - Digital (smart) tachograph VDO DTCO with Global Navigation Satellite System (GNSS) receiver and Dedicated short-range communications (DSRC) unit, compliant to EU Annex 1C tachograph regulation. - Speedometer with main scale in m/h and secondary scale in km/h. - Speed limiter setting for cruise control/accelerator pedal: 90 km/h. - Preparation for navigation consisting of a gps-splitter and gps-cable. - Radio/USB player. Speaker system with 2 speakers. - TruckPhone. Handsfree telephone kit with SIM card slot (for 2G or 3G network only) and Bluetooth antenna. Multipoint-Pairing enables simultaneous operation of two additional mobile phones from the steering wheel. - Standard antennas: AM/FM radio frequencies, 2x cellular for use by mobile phones, GNSS for location purposes. Extra: CB antenna. - ACC (Adaptive Cruise Control) with FCW (Forward Collision Warning) and AEBS-3 (AEBS: Advanced Emergency Braking System). With ACC a set distance to the traffic ahead can be maintained; safety systems FCW and AEBS assist in avoiding or mitigating the impact of an impending rear-end collision by alerting the driver and activating the brakes if necessary. - Driver Performance Assistant (DPA). Interactive programme to support the driver in achieving the most cost effective driving style. The DPA information is shown on the 5 inch full colour TFT display in the instrument panel.
<p>Safety and security</p>	<ul style="list-style-type: none"> - Lane Departure Warning System to prevent inadvertent lane changes due to driver's fatigue or distraction and to form an effective driving aid in low visibility conditions. - Electronic Vehicle Stability Control system (VSC) to enhance the active driving safety. Improved directional stability (understeer, oversteer jack-knifing) and additional roll-over safety. - Acoustic reverse warning with override switch. - Basic engine immobiliser.

Detailed Specification XF 530 FAX 8X2 Rigid POV for 6.4m W/Base (530)

Suspension and axles

- Front axle type 183N, 112 mm vertical offset. Parabolic leaf suspension with shock absorbers and stabiliser. Max. load 2x 9.0 tonnes.
- Air suspended driven rear axle and steered trailing axle. Driven single reduction axle type SR1347 with 4 air bellows, max. load 11.5 tonnes. Steered axle with 2 air bellows, max. load 7.5 tonnes. Mechanical differential lock.
- Axle load limiter 11.5 t.
- Lifting device for the steered trailing rear axle.
- Manual control to lift the leading and/or trailing rear axle(s) by operating a switch provided the axle load on the driven rear axle(s) is below its maximum.

Wheels and tyres

- Front axle(s): tyre size 385/55R22.5, wheel size 22.5 x 11.75.
- Second front axle: tyre size 385/55R22.5, wheel size 22.5 x 11.75.
- Driven rear axle(s): tyre size 315/70R22.5, wheel size 22.5 x 9.00.
- Trailing axle: tyre size 315/70R22.5, wheel size 22.5 x 9.00.
- Supplier Goodyear.
- Steel disc wheels, silvergrey.
- Wheel protection rings with open centre section, colour silver-grey (RAL 9006).
- First front axle: tyre size 385/55R22.5, Goodyear type KMAXS2, load index 160/000, speed index K, application Steering - Regional. Tyre label: rolling resistance B - wet grip B - noise 71dB(A), Category A.
- Second front axle: tyre size 385/55R22.5, Goodyear type KMAXS2, load index 160/000, speed index K, application Steering - Regional. Tyre label: rolling resistance B - wet grip B - noise 71dB(A), Category A.
- Driven rear axle: tyre size 315/70R22.5, Goodyear type KMAXD2, load index 154/150, speed index L, application Traction - Regional. Tyre label: rolling resistance C - wet grip B - noise 72dB(A), Category A.
- Trailing axle: tyre size 315/70R22.5, Goodyear type KMAXS2, load index 156/150, speed index L, application Steering - Regional. Tyre label: rolling resistance C - wet grip B - noise 72dB(A), Category B.
- Spare wheel tyre not applicable.

Driveline

- Engine MX-13, multi torque 6 cylinder diesel engine, 12.9 litres. Output 390 kW (530 hp) at 1675 rpm. Maximum torque 2600 Nm at 1000-1400 rpm.
- Exhaust emission Euro 6.
- Eco performance: the speed control settings of a vehicle with Eco performance focus on fuel efficiency and driveability. The fuel efficient setting, which is automatically selected, can temporarily be switched off by pushing the Eco off button to increase the performance of the vehicle.
- Automated gearbox, TraXon, 12 speeds.
- Automated direct drive gearbox TraXon 12TX2620, ratio 16.69-1.00, 12 speeds.
- Traction aid 15.0 t.
- Automated gearbox software optimised for standard transport applications. Gearbox control version: Full.

Detailed Specification XF 530 FAX 8X2 Rigid POV for 6.4m W/Base (530)

	<ul style="list-style-type: none"> - Rear axle ratio 2.40. - Mechanical differential lock. - The ASR (anti-slip regulation) system prevents the driven wheels from slipping when accelerating at driving off and helps the vehicle to remain stable on critical road surfaces. - On-board diagnostics (OBD) system compliant with Euro VI Step E requirements.
<p>Brake system</p>	<ul style="list-style-type: none"> - MX Engine Brake. Hydraulically operated compression brake assembly integrated in the valve rocker group. The MX Engine Brake works simultaneously with the exhaust brake, resulting in a high combined braking power available at low engine rpm. - Park brake control with test position. - Ventilated disc brakes front and rear. Dual circuit air system with electronic control (EBS). Twin cylinder air compressor with heated dryer and economy mode.
<p>Chassis</p>	<ul style="list-style-type: none"> - Wheelbase 5.70 m / rear overhang 2.00 m. - Side member height 310 mm, thickness 8.5 mm. Full length inner reinforcement. - Standard location of chassis components. - Horizontal exhaust discharge at the side of the DPF/SCR unit via a low exhaust diffuser. - EAS unit positioned behind second front axle at the right-hand side of the chassis. - Horizontal battery box at the left-hand side. No spare wheel carrier. - Air tanks steel. - Aluminium fuel tank 340 litres at the right-hand side, height 620 mm. - Fuel tank at the right-hand side of the chassis. - 45 litres tank for AdBlue®, positioned at the left-hand side of the chassis. - Front underrun protection (FUP), according to EU directive 2000/40/EEC. - Spray suppression in the mudguards, according to directive 91/226/EEC. - Temporary rear light brackets. - Rear light unit with LEDs.
<p>Drawbar and trailer equipment</p>	<ul style="list-style-type: none"> - Drawbar cross member D-value 137 kN, Dc-value 92 kN, V-value 40 kN. - Pneumatic trailer connection with C-type couplings. - Electric trailer connection 24V with two 7-pin sockets. An additional 7-pin socket is mounted to connect the EBS system of the (semi-)trailer. Lighting / accessory & EBS cables with 7 pin connectors at each end.
<p>Bodies and preparations for bodying</p>	<ul style="list-style-type: none"> - Analogue body signals and warnings. - Connector for analogue engine speed control on the chassis. Control functions for engine speed adjustment, programmed engine speed selection, application speed limiter and remote engine start/stop. - The air suspension is lowered to its bump position as soon as the PTO is switched ON via receipt of a CAN message or hardwired signal.

Detailed Specification XF 530 FAX 8X2 Rigid POV for 6.4m W/Base (530)

	<ul style="list-style-type: none"> - CAN J1939 functions in application connector (chassis: A105; cab: A106). - Application connector for body functions on the chassis (A203). Electric signals for -Cab tilt locked- and -Engine running-. Power supply 24 V before and after contact. Spare wiring to the dashboard. - Loose supply of a wiring loom with LED-type side marker lights. - Chassis frame prepared for standard applications. - Body attachment BAM 3, with consoles type A.
Power take-off (PTO)	- First gearbox PTO type NH/1c, mounted on the centreline of the gearbox counter shaft, direct pump drive.
Electrical power supply	- Alternator 120 A, batteries 2x 230 Ah.
GVM and GCM	<ul style="list-style-type: none"> - Chassis weight related technical GVM max. 37000 kg. - Drawbar related max GCM 56.000 kg. - Driveline related max GCM 44000 kg class 2. - Type plate standard.
Application conditions	<ul style="list-style-type: none"> - Standard noise level. - Maximum ambient temperature 38 degrees. - Air intake high.
Service and maintenance	<ul style="list-style-type: none"> - Standard Warranty takes care of 1 year complete vehicle, 2nd year driveline and 1st year breakdown. - ITS service. - Warranty Plus - 2 Year Vehicle & 3 Year Driveline - takes care of all warrantable repairs on the vehicle for two years and on the driveline for a third year together with associated breakdown coverage. - Delete DAF 3 year Preventive Maintenance Package. - Service interval standard. - Delivery charge United Kingdom.
Vehicle delivery	<ul style="list-style-type: none"> - Whole Vehicle Type Approval (WVTA). - Minimum toolkit consisting of a 750 mm control lever, a 30/32 mm wheel nut wrench, an approximately 800 mm long torque pipe, a T20 and T30/T45 torx screw wrench and a towing coupling with pintle pin. - Vehicle delivery with 30 liters extra fuel.
Special request (POV)	- 6.40m WB 2.00m AE Remark; NO WVTA No further notes
Customer needs	
Dealer options	<ul style="list-style-type: none"> - Pre Delivery Inspection - Supply & Fit Number Plates - Calibrate & Seal Tacho - Supply & Fit Plating Certificate Holder - AdBlue Top Up - Valet

Cheesewedge Body

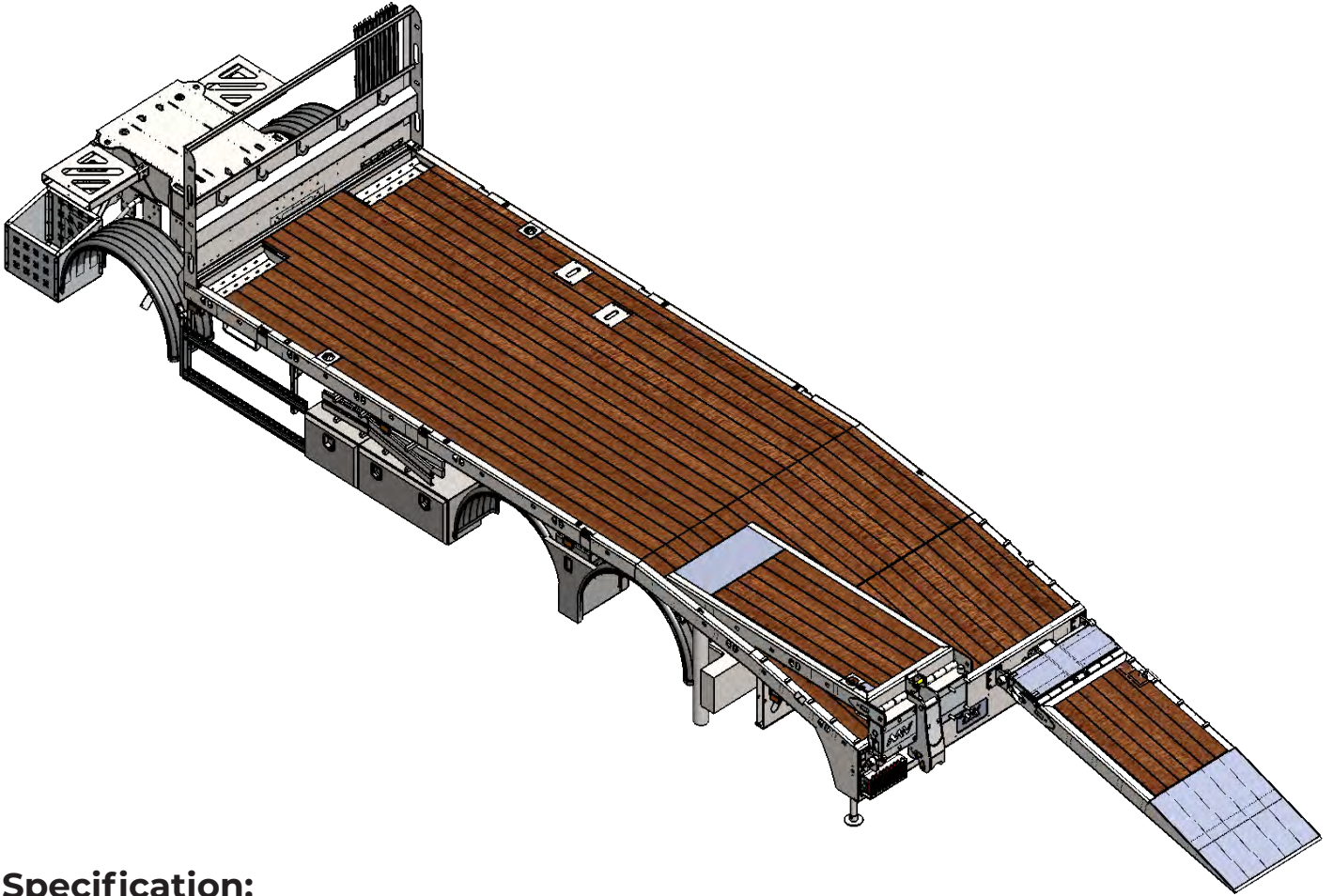

Specification:

- Fully Approved (IVA) bodywork Double crank hydraulic beavertail
- Body length to suit – up to overall vehicle length of 12m
- Fully welded interlaced steel construction (high strength to support payload – payload varies across chassis range)
- 400mm spacing cross-members
- Pressed laser cut side raves
- Full load restraint facilities built into side raves
- Headboard- 1200mm high – Steel bolt on type
- Large Chain hooks fitted to headboard
- 3' Chain hooks for holding large 4 leg chains
- Front Chain Wells – open type box to rear of headboard.
- Access Plate for winch fitment if required.
- Access step & grab handle fitted to front LHS
- Rope hooks to as many cross-members as possible
- 1-off 1000mm & 1-off 600mm Tool Lockers fitted to LHS of body
- Fall arrest system with storage for polls on front side of headboard
- Fall arrest slots to be positioned through side rave
- 28mm Hardwood Keruing Decking (sits slightly above steel bearers)
- Spray Suppression to current legislation
- LED marker lights to current legislation
- Side Guards to current legislation
- Rear/Side/Front Marker LED Rubber Stalks
- Conspicuity tape fitted to current legislation
- Grouser bars to outside edges of each ramp
- Winch behind headboard (accessed from cut out in headboard)
- Sectional ladder stowed under body
- Stainless steel hydraulic cylinders to prevent chipping with safety check valves
- Automatic hydraulic deploying stabiliser legs
- Prepared for drawbar hitch

Cheesewedge Body

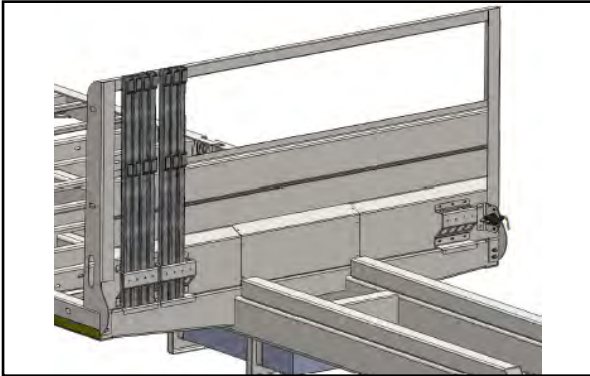

HEADBOARD

A 1200mm bolt on headboard is fitted to the front of the truck body, separating the usable body length with the area left for the Crane.

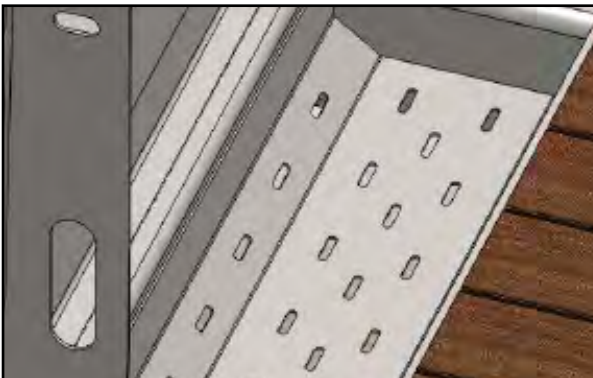

PERFORATED CHAIN WELLS

Deep chain well strategically placed below chain hangers. A perforated plate ensuring that road dirt and water are easily removed, keeping chains clean and organised.



13.4 TON PULL-OUT LASHING POINTS.

A drop forged lashing ring tested to 13.4 TON load. The ring is shaped to slide within to sleeves welded into the chime, increasing the strength of the lashing point and spreading the load. When not in use, the lashing lies down below the top of the chime. When pulled up the lashing ring can stay up until lowered back down below the chime.

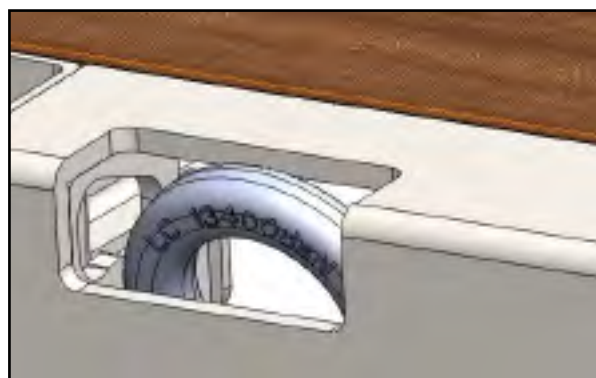

Cheesewedge Body

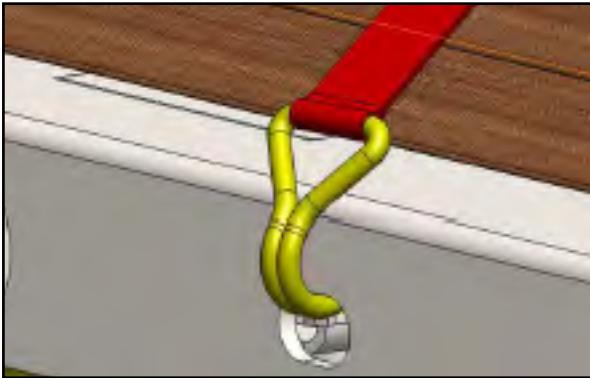

ANTI-SLIP RATCHET STRAP CUT-OUT

A profiled chime which allows for ratchet strap ends to be easily secured to the body of the truck. The size of the cut-out is designed to give optimum ease of use, while stopped the ratchet end from falling back out of the cut-out. This allows for a single operator to load a truck.

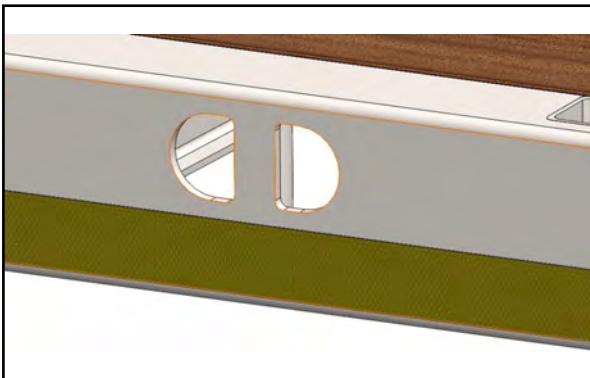

CONSPICUITY TAPE

Full length reflective tape on both sides. Side chime is deep enough to ensure that tape is not damaged when tying down loads.

Choice of yellow or white tape.



CHAIN-THROUGH CUT-OUT

A cut-out in the chime to allow for a chain to be pulled through when securing a load. A reinforcing round bar is welded to the inside to add to load bearing strength.
(this is NOT a load tested lashing point)



Cheesewedge Body

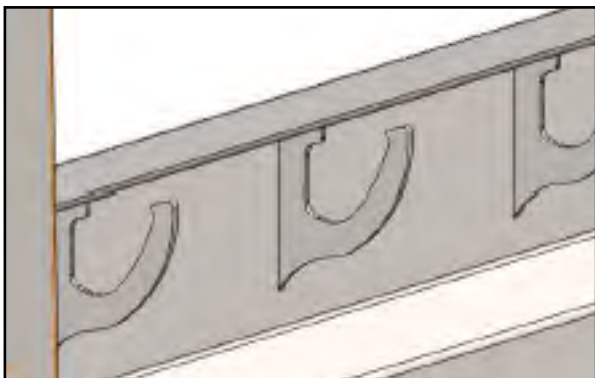

3' CHAIN HOOKS ON HEADBOARD

A large 3inch chain hook suitable for holding up to 4 master chain links.

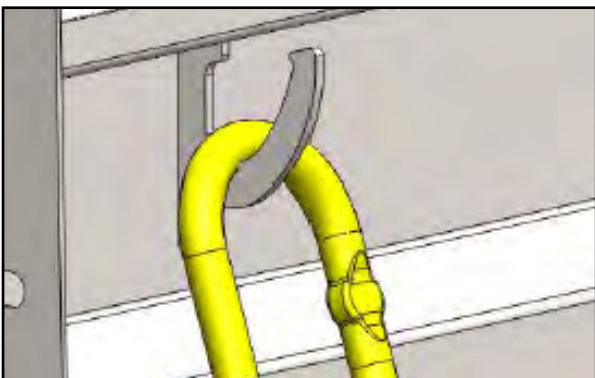

Optional Extras Available:

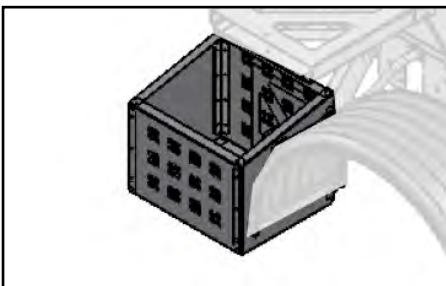

Galvanised
Chain Basket



CHAIN CARRIER
BETWEEN REAR
AXLES

PALFINGER LOADER CRANES

Benefits that lift us above the competition



POWER LINK PLUS

With the 15-degree reverse linkage system, you can reach through low openings and inside buildings.



LOW MAINTENANCE EXTENSION SYSTEM

With sliding elements made of synthetic material, and high quality KTL coating, the boom system significantly simplifies operations saving time and money as well as protecting the environment.



HIGH SPEED EXTENSION

High Speed Extension speeds up the extension boom system for faster and more efficient working.

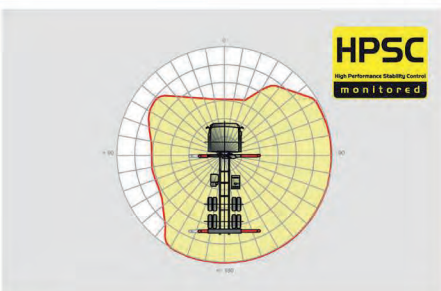

HPSC

Variable stabiliser position from the High Performance Stability Control (HPSC) system enables you to lift utilise maximum capacity even when working in tight spaces.



PAL 50

The custom-designed Paltronic 50 electronic system monitors and operates the crane, offering improved efficiency and safety.

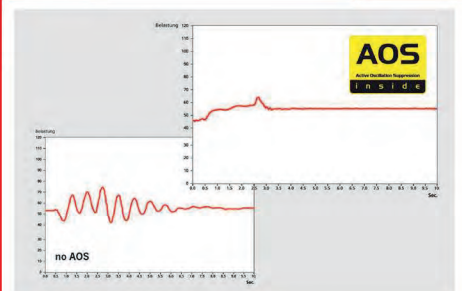

COATING TECHNOLOGY

The KTL coating foundation layer ensures perfect surface protection, with components then coated in either powder-coat or two-component-top coat. Palfinger's high quality coating ensures value retention and excellent corrosion protection for the life of the crane.



RADIO REMOTE CONTROL

Palfinger remote controls are equipped with linear lever or cross lever, with a comfortable and ergonomic design.

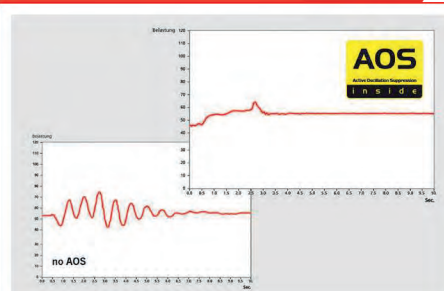

AOS Active Oscillation Suppression system prevents 'post-oscillation' resulting from rapid braking or load changes. The stress peaks on the extension boom system are reduced, with material fatigue and wear minimised for crane longevity and increased resale value.



LIGHTING PACKAGE

LEDs which backlight the control panel make it easier for the operator to view the entire panel and read the crane functions during operation. LED warning lights in the supporting cylinders also mean greater safety for the operator and passers-by.

Palfinger PK62002 Crane with 6 Extensions

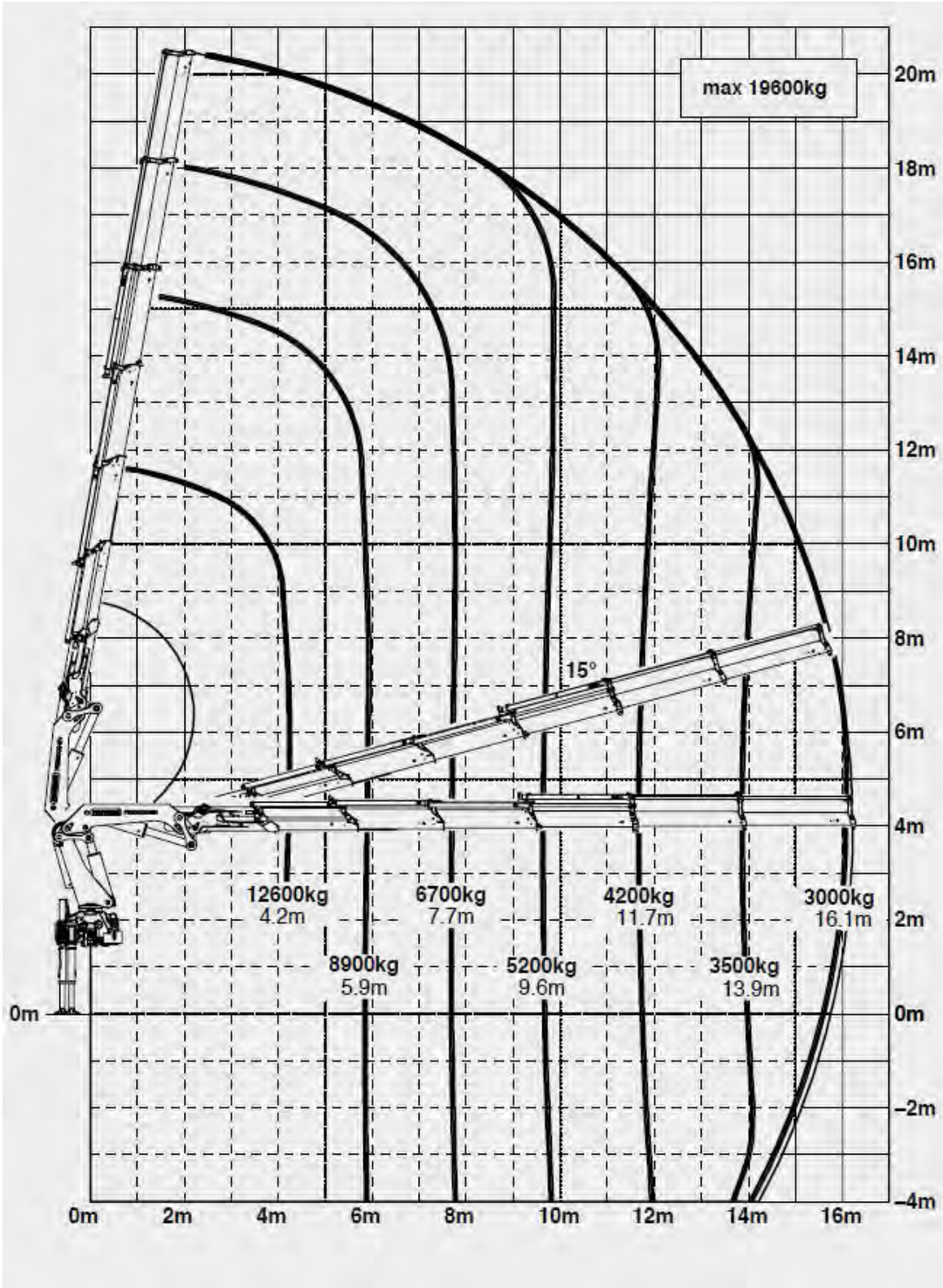

1. **Definitions**

- a. In these Conditions of Quotation: 'Buyer' means the person, company, group or firm placing an order with the Company 'Company' means MV Commercial Ltd 'Price' means the Price specified in the Quotation as set by the Company for the Goods 'Goods' means the product or parts thereof which the Company offers to supply in accordance to the terms as found in the Conditions of Quotation 'Modification' means any deviation, subtract or addition including the fitting of standard and non-standard parts 'Quotation' means the offer made by the Company to the Buyer of the Goods for the Price

2. **Formation of Contract**

- a. All Goods sold by the Company are sold subject to the Terms and Conditions as set out by the Conditions of Sale (not listed here) which form part of a contract between the Buyer and the Company and are subject to the laws of the United Kingdom.

3. **Basis of Quotation**

- a. The Quotation does not constitute a contract and is not binding between the Buyer and the Company
b. All details in the Quotation are not binding and are only commercial estimates to which the Company will make reasonable efforts to achieve, but can be subject to change without notice. These details include but are not limited to features, prices, quantities and delivery time.
c. In the case of any changes made by the Company to the Quotation as a result of but not limited to clerical error or omission in any sales literature, quotation or price agreement, shall not result in any liability on the part of the Buyer
d. The Company reserves the right at any stage to re-negotiate any contract, cost agreement or any relevant commitment should any information provided by either the Buyer or the Company change or deviate from the original quotation or agreement.
e. This quotation is valid for a period of 30 Days from the date of publication unless notified by the Company in writing.

4. **Price of Goods**

- a. The Price of the Goods shall be set out in the Company's Quotation
b. The Company reserves the right to modify the Price of the Goods before delivery and by giving notice to the Buyer as a result of any increase or decrease in cost to the Company due to any factor beyond the Company's control
c. Unless indicated otherwise, Prices contained in the Quotation do not include Value Added Tax which the Buyer will be required to pay to the Company
d. The Company retains its absolute discretion to refuse to grant credit

5. **Goods Modifications**

- a. Any request on the part of the Buyer for any Modification made to any Goods shall be made in writing to the Company for agreement and in accordance with relevant safety and conformity standards.
b. Any request on the part of the Buyer for any Modifications to be made after the Quotation has been issued may result in changes being made to the Price and delivery date

6. **Force Majeure**

- a. All details, Prices and delivery dates that are included in the Quotation are subject to Force Majeure. The Company shall not be held liable to the Buyer for any loss, delay or damage caused by a reason beyond the Company's control including but not limited to Act of God, accidents, natural or environmental reasons including but not limited to floods or fires, power failures, or industrial action

7. **Governing Law**

- a. All Terms of Trading and conditions set out in the Quotation between the Company and the Buyer are subject to and construed in accordance with the laws of England and all parties subject to the Quotation hereby submit to the exclusive jurisdiction of the courts of the United Kingdom



BUILT FOR WORK

DESIGN • BUILD • LEASE • HIRE • SALES

MV COMMERCIAL'S UK-WIDE FACILITIES



AIRDRIE, SCOTLAND

The home of our Head Offices, this state of the art site offers full Sales and Hire services.

**Ninian Road,
Brownsburn Ind Est,
Airdrie,
ML6 9SE**

- Sales and Hire
- MOT Preparations
- VOSA Test Lanes
- Repair Workshops
- Fabrication Workshops
- Paintshop with 8 Booths
- Crane Fitting & Testing
- Livery Application
- Livery & Logo Design
- Engineering

LIVINGSTON, SCOTLAND

Our offices in Livingston, Scotland offer Truck & Van hire and sales options.

**Muir Road,
Houstoun Ind
Est, Livingston,
EH54 5BY**

- Sales & Hire Depots
- MOT Preparations
- Crane fitting & Testing
- Livery Application

HAYDOCK, ENGLAND

Our Haydock Depot oversees hire and sales services for Central England and Wales. We also offer MOT Preparations and Mobile Servicing.

**Millfield Lane,
Haydock,
St. Helens,
WA11 9GA**

- Sales & Hire Depot
- Mobile Servicing
- Workshop Services
- MOT Preparations
- Repairs
- Fabrication

LUTON, ENGLAND

Our Luton Depot oversees hire and sales services for the South of England. They also provide repair and fabrication services.

**Watling Street,
Flamstead,
Hertfordshire,
AL3 8HB**

- Sales & Hire Depot
- Mobile Servicing
- Workshop Services
- MOT Preparations
- Repairs
- Fabrication

**Visit Our
NEW SUPERSITE IN
AIRDRIE, SCOTLAND.**

**01236 280 280
MVCOMMERCIAL.COM**